

Ref 2020; Land for sale in a single-family or multi-family house in Palma, El Terreno

Palma - El Terreno · Buy · Ref 2020

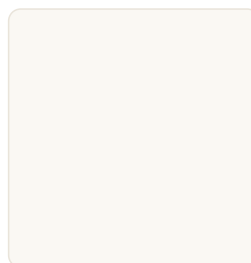
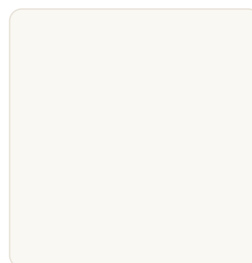
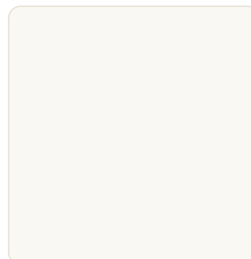
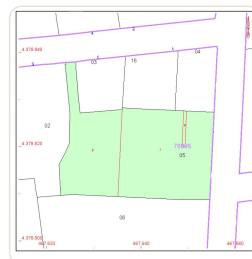

DESCRIPTION

Plot of land with 600m² for sale in the middle of the El Terreno neighborhood, between the Paseo Marítimo and the Bellver Park. Up-and-coming hip area. Neighborhood in full development. Very interesting investment! Possible options: – Possibility of building a single-family house – Possibility of building an apartment building – Possibility of living space: 280m² – Possibility to build 2 floors plus underground parking: ground floor + upper floor with a total height of 8.50 m – Possibility to build a swimming pool on the rest of the plot – Possibility of building an underground car park In total, there is a possibility to build 7 apartments of 68 m² each.

FACTS

Region	Status
Palma - El Terreno	Buy
Living space	Property
280 m ²	600 m ²
Floors	
3	

CONTACT US

e-mail: info@el-terreno-immo.com

Telephone: 0034 971 284 026

Mobile / WhatsApp: 0034 637 128 058

Av. Joan Miró 82, 07015 Palma



Scan for more info